

Repairing Separating walls using Cem-Fix

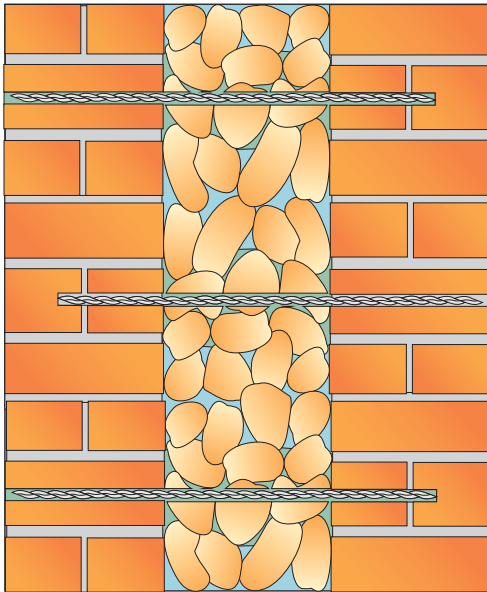

Rubble Fill Wall

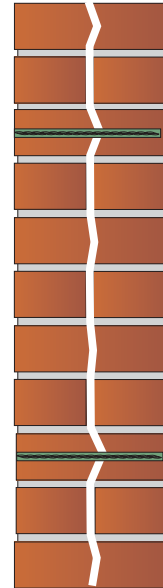

Solid Wall

(1) Drill clearance holes (13mm-16mm diameter depending upon material and length of tie to be used) to specified depth and at required vertical spacing.

(2) Blow out holes and thoroughly flush with water.

(3) With the aid of a grout gun, pump Cemspand cementitious grout to outlet of nozzle. Insert nozzle to full depth of drilled hole and pump grout to fill hole. Maintain pressure on gun while retrieving nozzle to ensure that all voids are filled with grout.

(4) Wind correct length Cem-fix into hole using Fast-fix support tool. Make good all holes at surface with colour matching dyed mortar.

Installation Notes: Unless specified otherwise the following criteria are to be used.

a) Cem-fix to be installed at the same density as remedial wall ties 2.47 per square metre using horizontal centres of 900mm and vertical centres of 450mm with additional Cem-fix installed either side of openings at 300mm vertical centres.