

# Speed-fix WALLFAST Limited

Speed-fix is a multi purpose headless fixing, that can be installed like a nail and performs like a screw. With no need of any wall plugs. Installing Speed-fix is the quickest way of joining timber carcass or mouldings to all types of masonry. Speed-fix can be hammered straight through timber and Air-Crete blocks or fix timber to harder masonry materials by using a pilot hole. In addition it is a very strong structural timber to timber fixing which will not come apart under spring tension loads. Speed-fix can also be used to tie frames to bed joints. Speed-fix has a small core diameter which allow it to be used in thin timbers without causing splitting while still conforming to CP112 1972, unlike standard wire nails

## Features

- Headless stress free fixing.
- Austenitic 304 or 316 Stainless Steel.

## Benefits

- Easy and problem free installation.
- No wall plugs needed.

## Fixing timber to masonry.

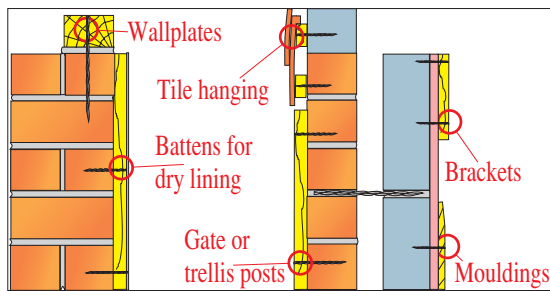

## Uses

- Fixing Vertical tile battens.
- Fixing Dry lining Battens.
- Fixing Door/Window frames.
- Fixing Mouldings.
- Fixing Gate and trellis post.
- Fixing Wall-plates.
- Fixing Rad & cupboard brackets.

## Fixing timber to timber.

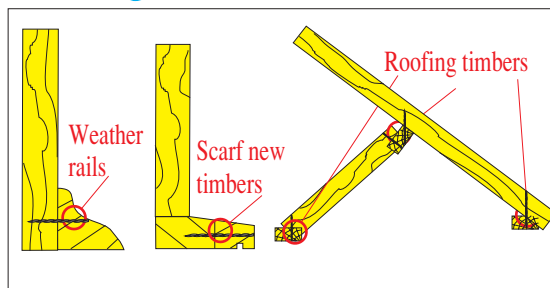

## Uses

- Fixing Weather rails.
- Fixing Scarf timbers.
- Fixing Purlins & Raking struts.
- Fixing Decking.

## Fixing timber to bed joints

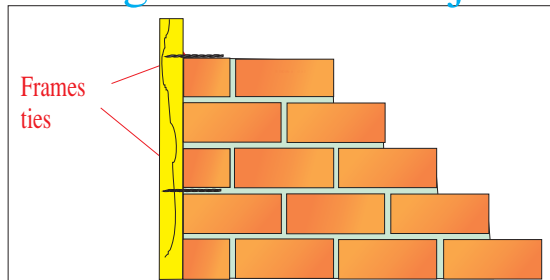

## Uses

- Fixing Timber Window frames.
- Fixing Timber Door frames.
- Fixing Timber Garage door frames.
- Fixing External Timber posts.